

Town of Alton, Indiana Base Map

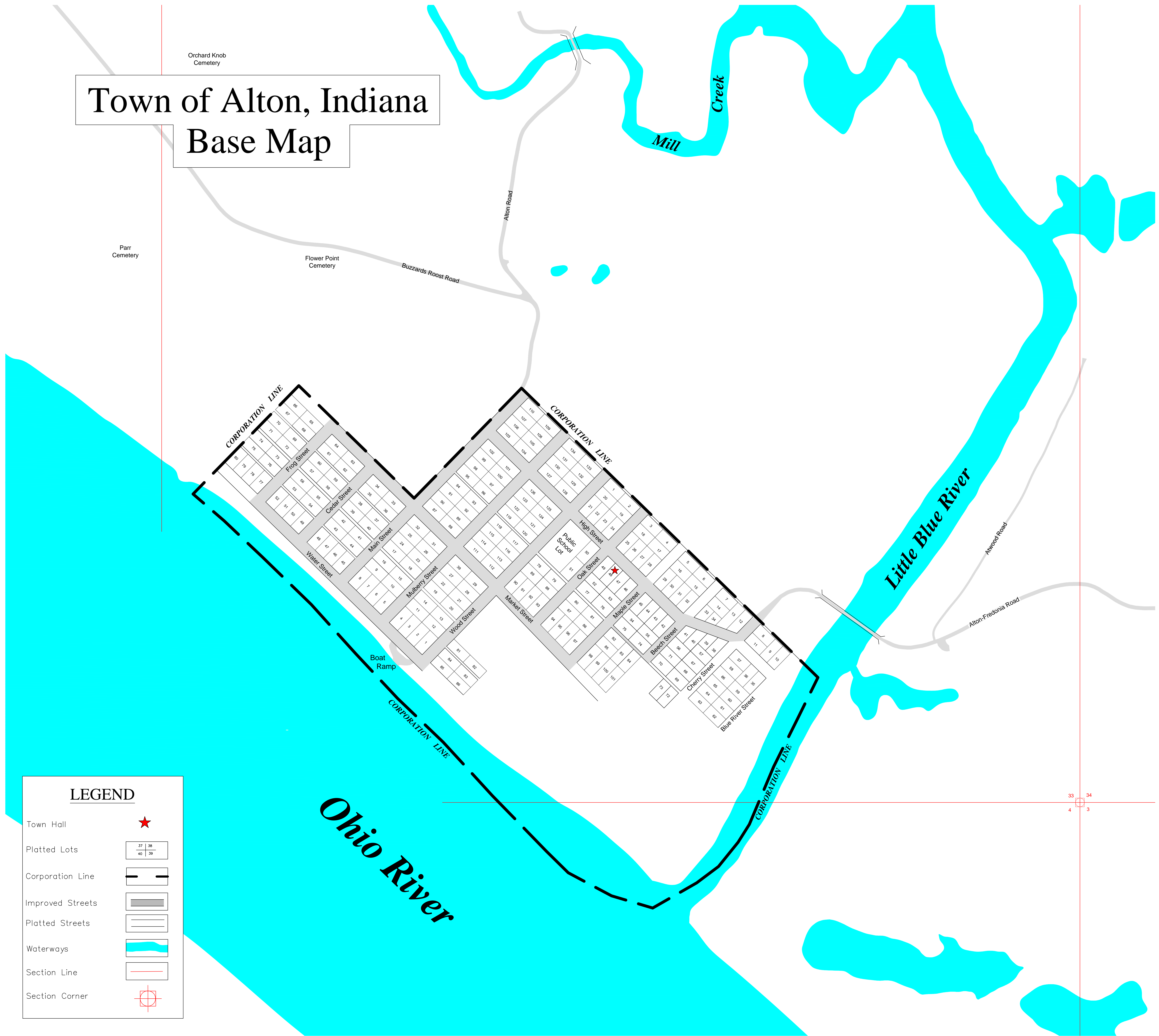

LEGEND

- Town Hall
- Platted Lots
- Corporation Line
- Improved Streets
- Platted Streets
- Waterways
- Section Line
- Section Corner

The information located upon the Alton, Indiana Base Map is provided by Indiana 15 Regional Planning Commission. The data provided herein was compiled using various sources. The sources include:

- Alton Plat Maps from the Crawford County Auditor's Office;
- Miscellaneous surveys and deeds recorded in the Crawford County Recorder's office;
- Alton Town Ordinances that annex territory and vacate streets up to and including Peckenpaugh Addition 1889;

Some of these sources had conflicting boundary descriptions and lots that did not fully close. Any person who relies on said information does so solely at their own risk. While the Indiana 15 Regional Planning Commission worked diligently to piece the legal documents, this data is provided as is without warranty.

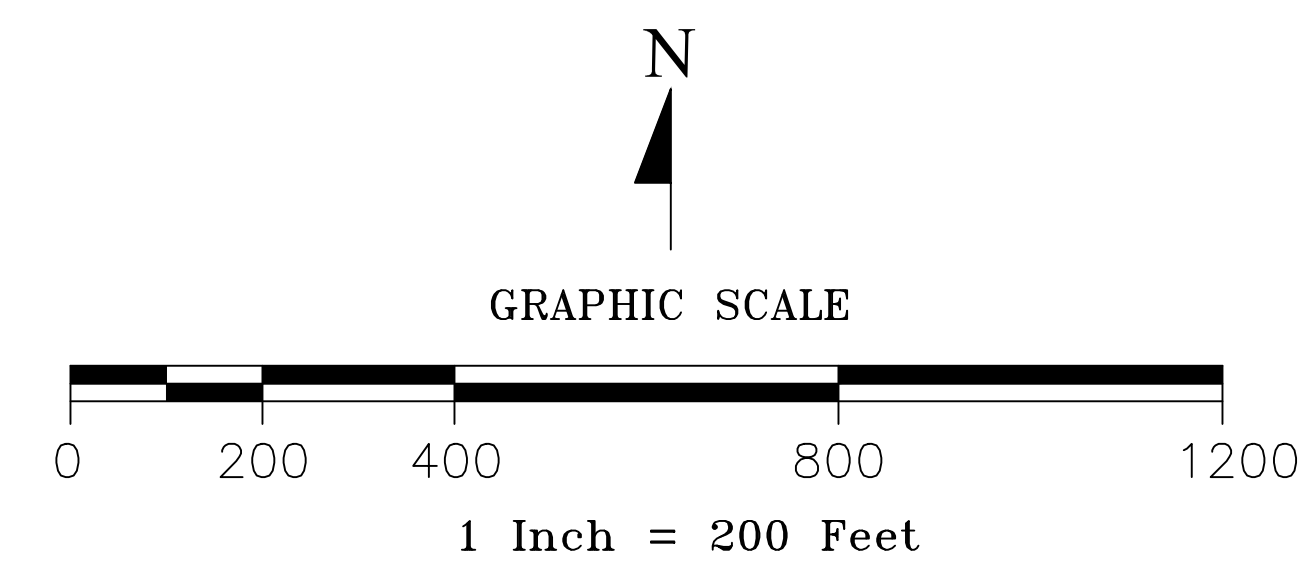

INDIANA 15 REGIONAL PLANNING COMMISSION		
221 East First Street Ferdinand, IN 47532		PHONE: (812) 367-8455 FAX: (812) 367-8171 Website: www.ind15pc.org
Title: TOWN OF ALTON, INDIANA - BASE		
Prepared by: T.E.M. & E.E.	Reviewed by: L. G.	Orig: March 7, 2013
Revisions:		
N:\Counties\Crawford\Maps\Base Maps\Cottim\Alton		
© Copyright 2013 Indiana 15 Regional Planning Commission		

33 34
4 3