

Town of Chrisney, Indiana Base Map

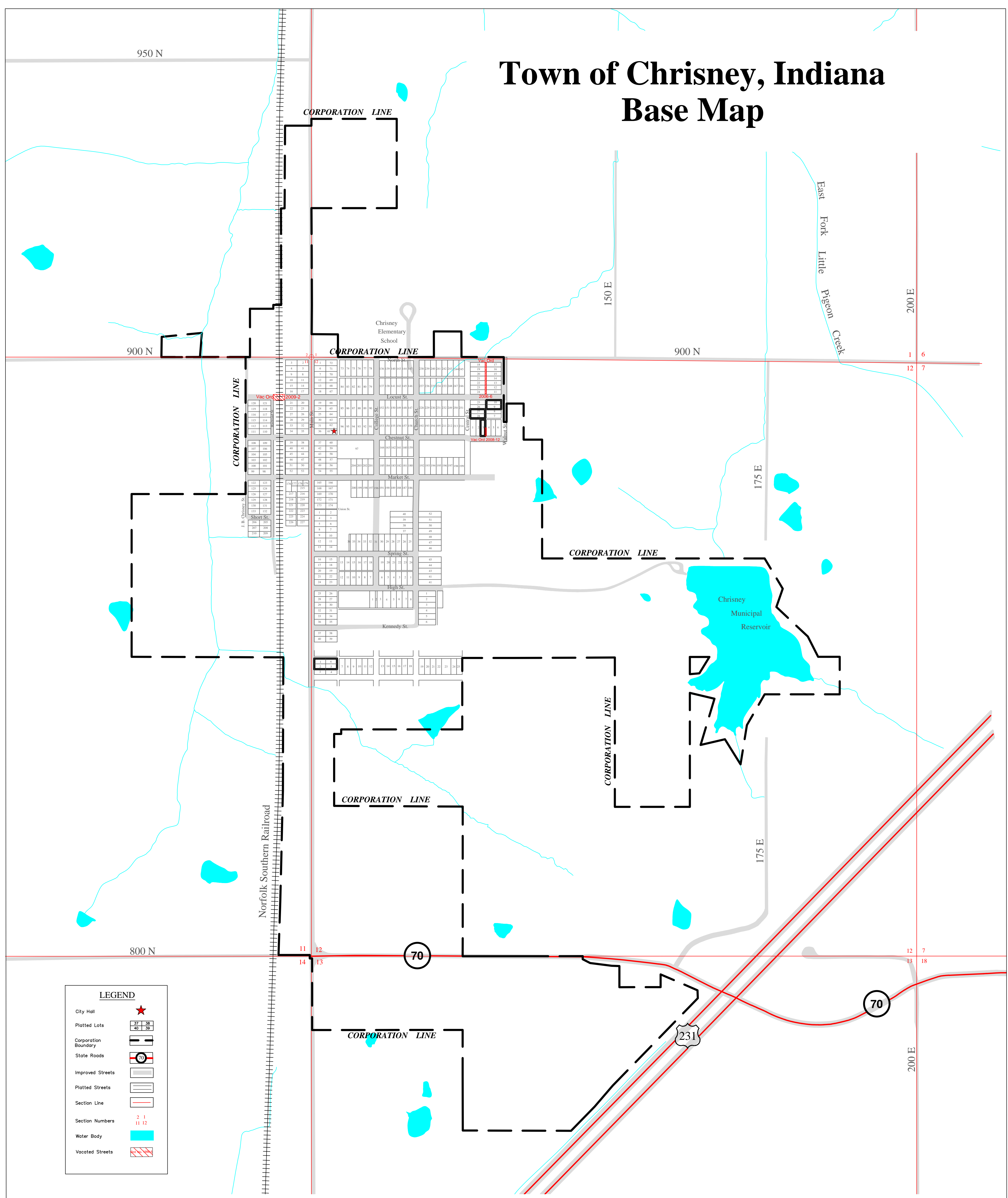

LEGEND

- City Hall
- Platted Lots
- Corporation Boundary
- State Roads
- Improved Streets
- Platted Streets
- Section Line
- Section Numbers
- Water Body
- Vacated Streets

The information located upon the Chrisney Indiana Base Map is provided by Indiana 15 Regional Planning Commission. The data provided herein was compiled using various sources. The sources include:

- Chrisney Plat Maps from the Spencer County Auditor's Office;
- Miscellaneous surveys and deeds recorded in the Spencer County Recorder's office;
- Chrisney Town Ordinances that annex territory and vacate streets up to and including Ordinance Number 2008-9

Some of these sources had conflicting boundary descriptions and lots that did not fully close. Any person who relies on said information does so solely at their own risk. While the Indiana 15 Regional Planning Commission worked diligently to piece the legal documents, this data is provided as is without warranty.

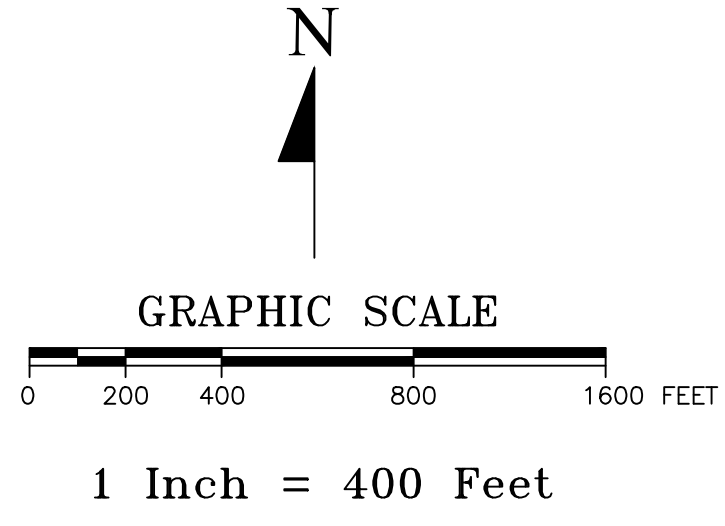

	INDIANA 15 REGIONAL PLANNING COMMISSION 221 East First Street Ferdinand, IN 47532 PHONE: (812)367-8455 FAX: (812) 367-8171 Website: www.ind15rpc.org	
	Title: Town OF CHRISNEY, INDIANA- BASE MAP	
Prepared by: E.E; T.E.M.	Reviewed by: L. G.	Date: March 8, 2011
Revisions:		
N:\Counties\Spencer\Maps\Base Maps\Spencer County Communities\Chrisney Base		
© Copyright 2011 Indiana 15 Regional Planning Commission		