

Town of Orleans, Indiana Base Map

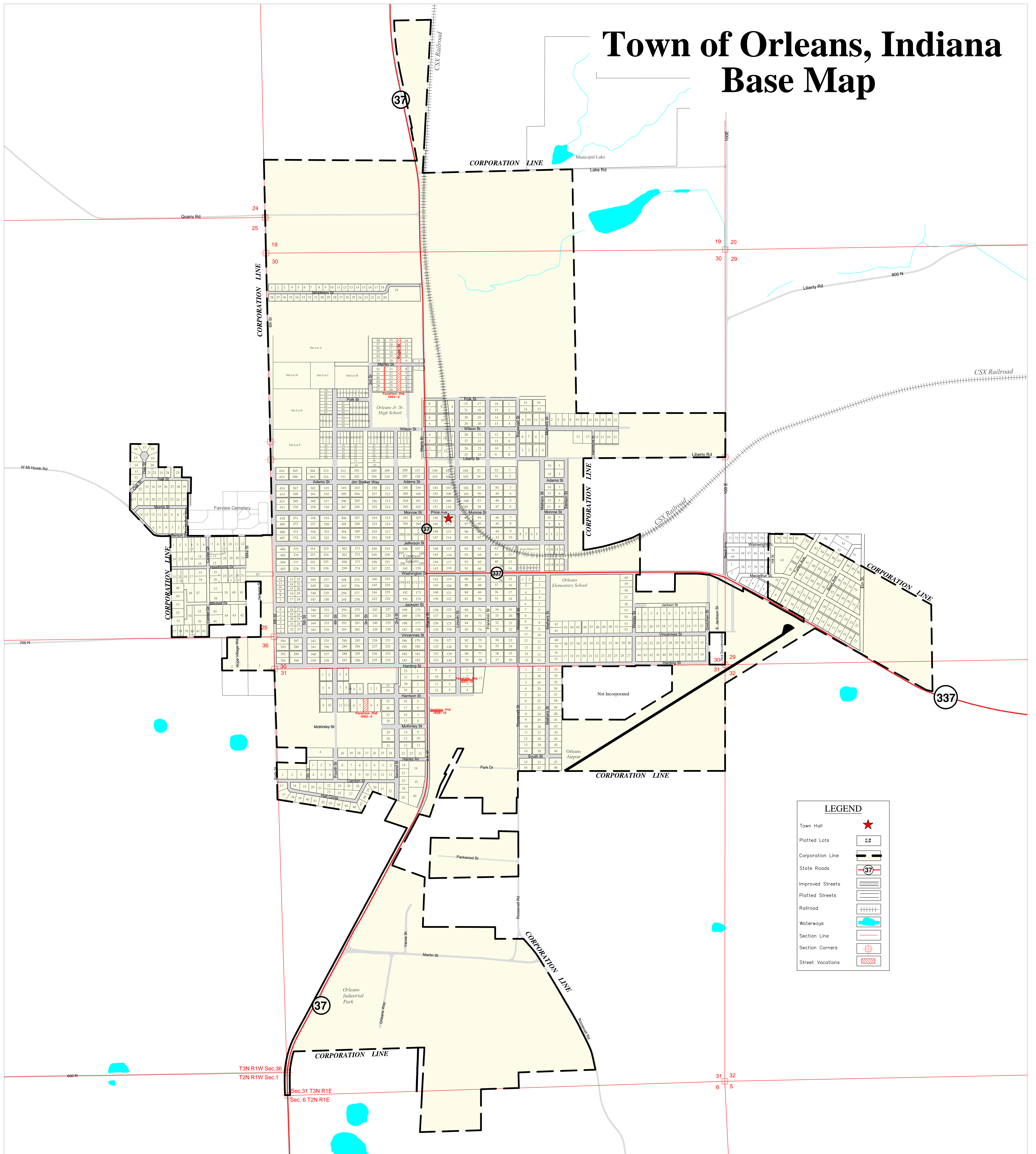

The information located upon the Orleans Indiana Base Map is provided by Indiana 15 Regional Planning Commission. The data provided herein was compiled using various sources. The sources include:

- Orleans Plat Maps from the Orange County Auditor's Office;
- Miscellaneous surveys and deeds recorded in the Orange County Recorder's office;
- Orleans Town Ordinances that annex territory and vacate streets up to and including Ordinance Number 2012-7
- U.S. Census Bureau Boundary and Annexation Surveys.

Some of these sources had conflicting boundary descriptions and lots that did not fully close. Any person who relies on said information does so solely at their own risk. While the Indiana 15 Regional Planning Commission worked diligently to piece the legal documents, this data is provided as is without warranty.

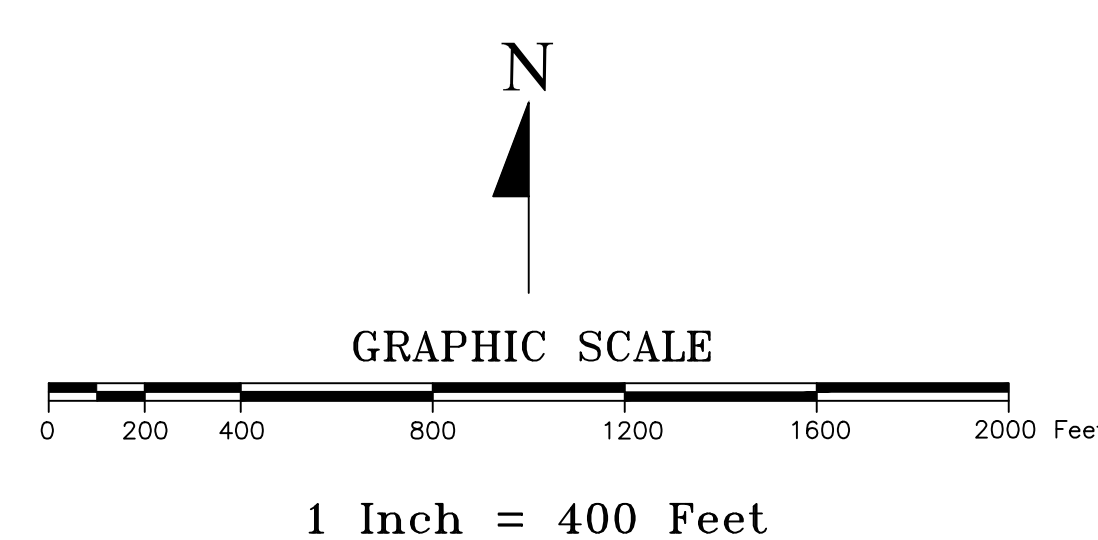

LEGEND	
Town Hall	★
Platted Lots	⊞
Corporation Line	—
State Roads	37
Improved Streets	—
Platted Streets	—
Railroad	—
Waterways	—
Section Line	—
Section Corners	⊞
Street Vacations	—

INDIANA 15 REGIONAL PLANNING COMMISSION	
221 East First Street Ferdinand, IN 47532	PHONE: (812) 367-8455 FAX: (812) 367-8171 Website: www.ind15rpc.org
Title: Town of Orleans, Indiana - Base Map	
Prepared by: E.E. T.E.M.	Reviewed by: L. G.
Date: July 11, 2012	
Revisions:	
N:\Counties\Orange\Maps\Base Maps\Orange County Communities\Orleans	
© Copyright 2012 Indiana 15 Regional Planning Commission	